

# KINETIC



## KINETIC

Telescopic Glass Railing  
„Unobstructed View“







Comfort and aesthetics are all together with Kinetic Systems! Never compromise from a continuous, panoramic view advantage. Feel the distinctiveness in architecture with portable or ground fixed telescopic glass wind barrier systems.

As a company that develops global solutions in the fields of architecture and engineering, Libart is preferred all over

the world for 25+ years by architects and professionals who want to make a difference for restaurants, cafes, hotels, commercial facilities, residential buildings and industrial zones with its retractable architectural systems. Kinetic Systems (FC and FB) are designed completely with tempered glass. One of the major benefits that Kinetic systems provide is the lack of horizontal frame and counter weight profiles that

prevents visual clutter, which can make all the difference. Since they do not contain any horizontal profiles, Kinetic systems establish an unobstructed interaction with the view, offering high permeability and so, provide benefits to both customers and business owners for many years by addressing a wide portfolio of projects as residentials, hotels, shopping centers, cafes and restaurants.

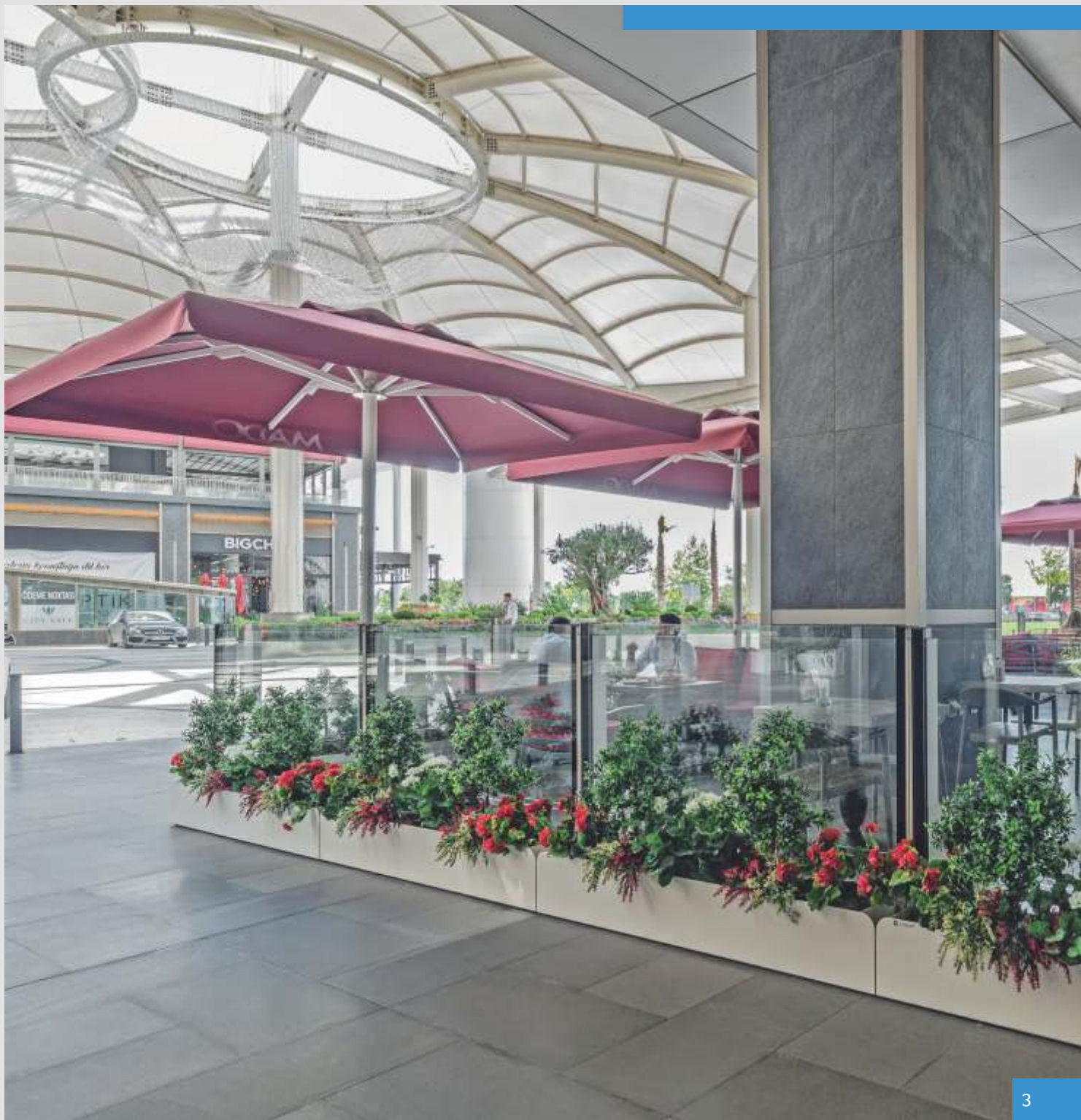

# Kinetic KU-FC

## Fixed to Ground Telescopic Glass Railing Systems

Designed completely with tempered glass, Kinetic systems do not contain any horizontal profiles, providing a continuous view. You can push down the top sliding frame at any time you want and enjoy the view. With high resistance to wind loads, other physical factors and aesthetic integrity, it ensures beautiful vistas in your spaces. Because the Kinetic FC is fixed to the ground, it provides high wind resistance and extra safety.

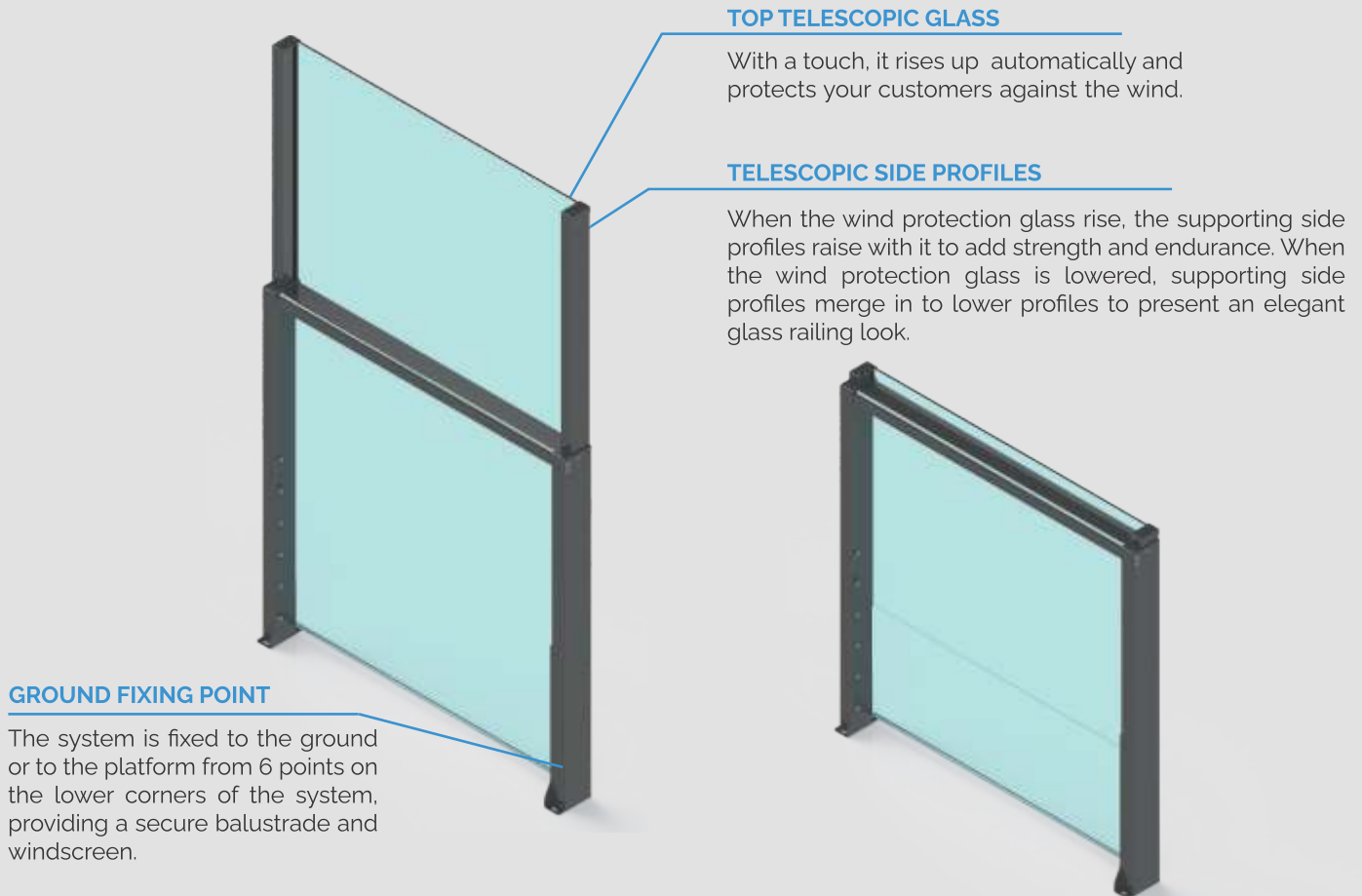

## TECHNICAL INFO

Max. Width	: 1,50m
Height	: 1,85m
Operation	: Semi-Automatic
Glazing	: <u>Standart:</u> Bottom&Top Telescopic Glass 6mm Tempered / Clear <u>Optional:</u> Bottom Fixed Glass 5+1.52PVB+5 T. Laminated Glass Top Telescopic Glass 6mm tempered
Material	: Aluminium AL 6063-T6
Standard Colors	: according to the RAL sample in any color
Feet	: must be fixed to the concrete or steel.

SYSTEM OPEN

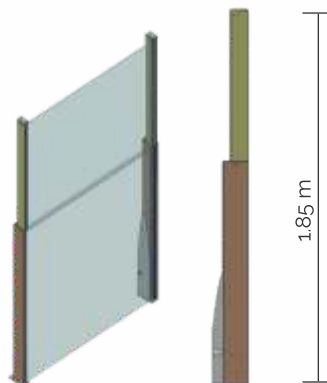

SYSTEM CLOSED

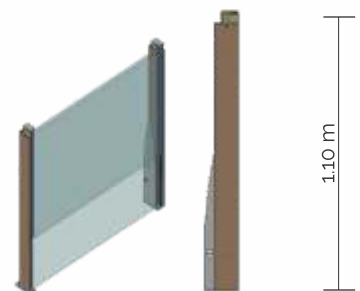

# KINETIC



## MONO CAFE



## M GALLERY ACCOR HOTEL



## SAKHALIN BODRUM RESTAURANT

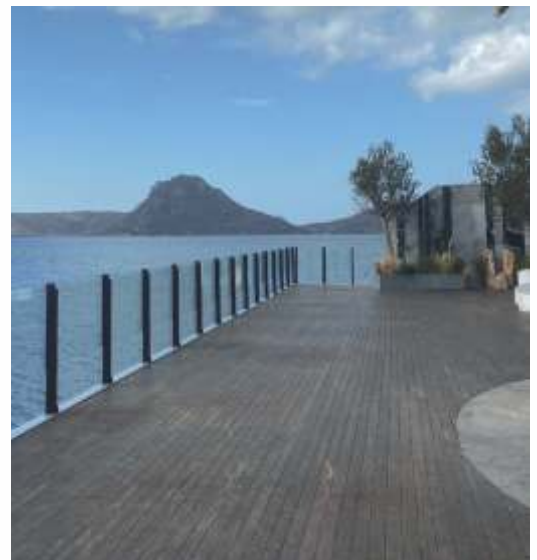

# Kinetic KU-FB

## Telescopic Glass Railing Systems / Planter (Portative)

Kinetic FB systems are designed portable with an integrated planter. The planter bears the load, obtaining resistance against the "wind". Kinetic FB systems can cater to a wide range of project portfolios such as residential, hotels, shopping centers, cafe-restaurants with a flexibility of plan provided by a portable design advantage and a landscape contribution by the planter that is integrated into the design.

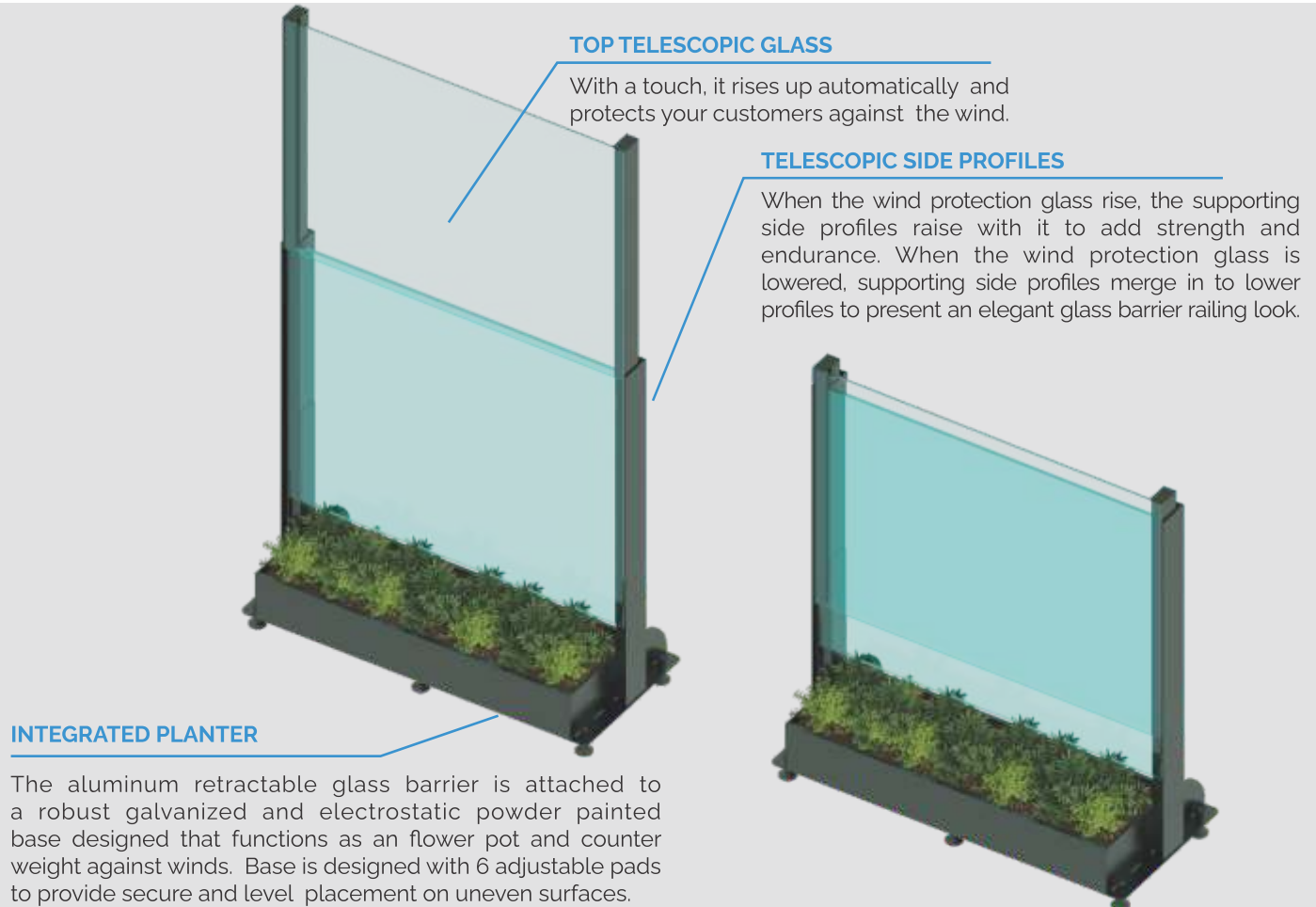

### TECHNICAL INFO

Max. Width	: 1,50m
Height	: 1,85m
Operation	: Semi-Automatic
Glazing	: <u>Standart:</u> Bottom&Top Telescopic Glass 6mm Tempered / Clear <u>Optional:</u> Bottom Fixed Glass 5+1,52PVB+5 T. Laminated Glass Top Telescopic Glass 6mm tempered
Material	: Aluminium AL 6063-T6
Planter	: 15 cm x 32 cm x"
Standard Colors	: according to the RAL sample in any color

#### SYSTEM OPEN

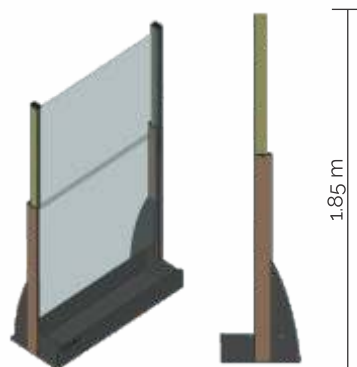

#### SYSTEM CLOSED

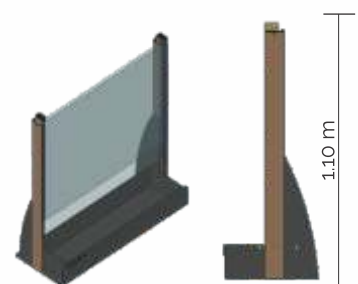

\* The content of the planter is not provided by Window Works. For safe use, the planter should be filled with 7 cm gravel, 7 cm wet soil (Approximately 80 kg).  
\*\* The internal width of the planter is 10 cm shorter than the module width.

# KINETIC



## MADO ISTMARINA



## HOTEL WIND BREAKER

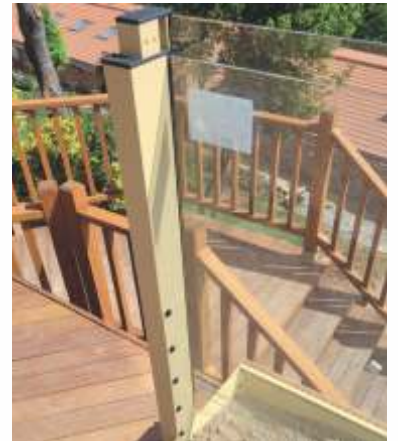

## GODIVA ZORLU CENTER





# KINETIC

Telescopic Glass Railing Systems

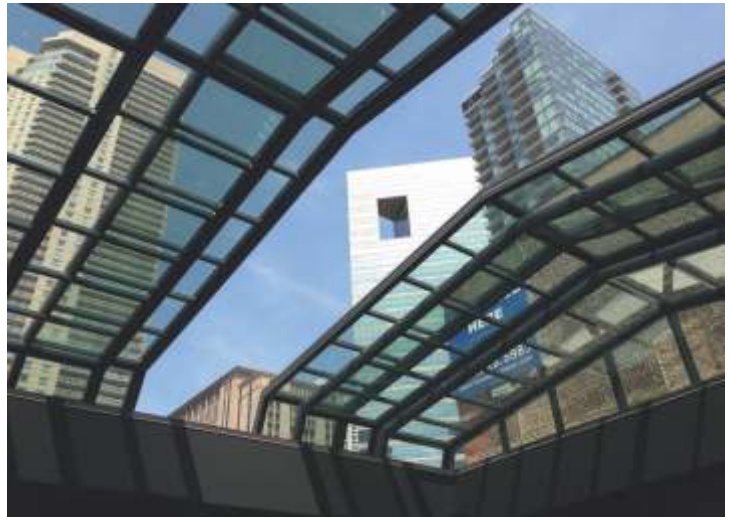

Libart designs and fabricates operable architectural systems for discerning architects and professional clients from around the world. Libart's aluminum and glass retractable structures are innovative, functional and aesthetically attractive. They are used in restaurants, cafes, hotels, commercial and residential and industrial facilities. Our commitment to research, design, engineering and manufacturing is based on providing our customers value added retractable structures that offer flexible living and working environments, for any type of weather.

Libart has been serving the architectural industry with operable solutions for over 25+ years, with manufacturing centers located in 4 countries and sales offices more than 40+ countries.

Since 2023, Window Works brings Libart products to the central European market.

To learn more about our systems and projects from around the world please visit us at [www.windowworks.eu](http://www.windowworks.eu)